



RAGAS DENTAL COLLEGE & HOSPITAL

(Unit of Ragas Educational Society)
Recognized by the Dental Council of India, New Delhi
Affiliated to The Tamilnadu Dr. M.G.R. Medical University, Chennai
2/102, East Coast Road, Uthandi, Chennai - 600 119. INDIA.
Tele : (044) 24530002, 24530003 - 06. Principal (Dir) 24530001
E-mail : principal@rdc.ac.in, web : www.rdc.ac.in

S.No	Name of the student and year of study	Year of Training
1.	Indumathi.S - III Yr PG	2020
2.	Ragamalika.S - III Yr PG	2020
3.	Meenakshi. R.P - II Yr PG	2020
4.	Davis Navin - II Yr PG	2021
5.	K.Gayathri - II Yr PG	2021
6.	Lakshmi Prasanna - II Yr PG	2021
7.	Shanmugapriya - II Yr PG	2021
8.	Aswathy - II Yr PG	2021

List of students trained in laser treatment:

IMAGING AND MORPHOMETRIC SOFTWARES

DOLPHIN SOFTWARE

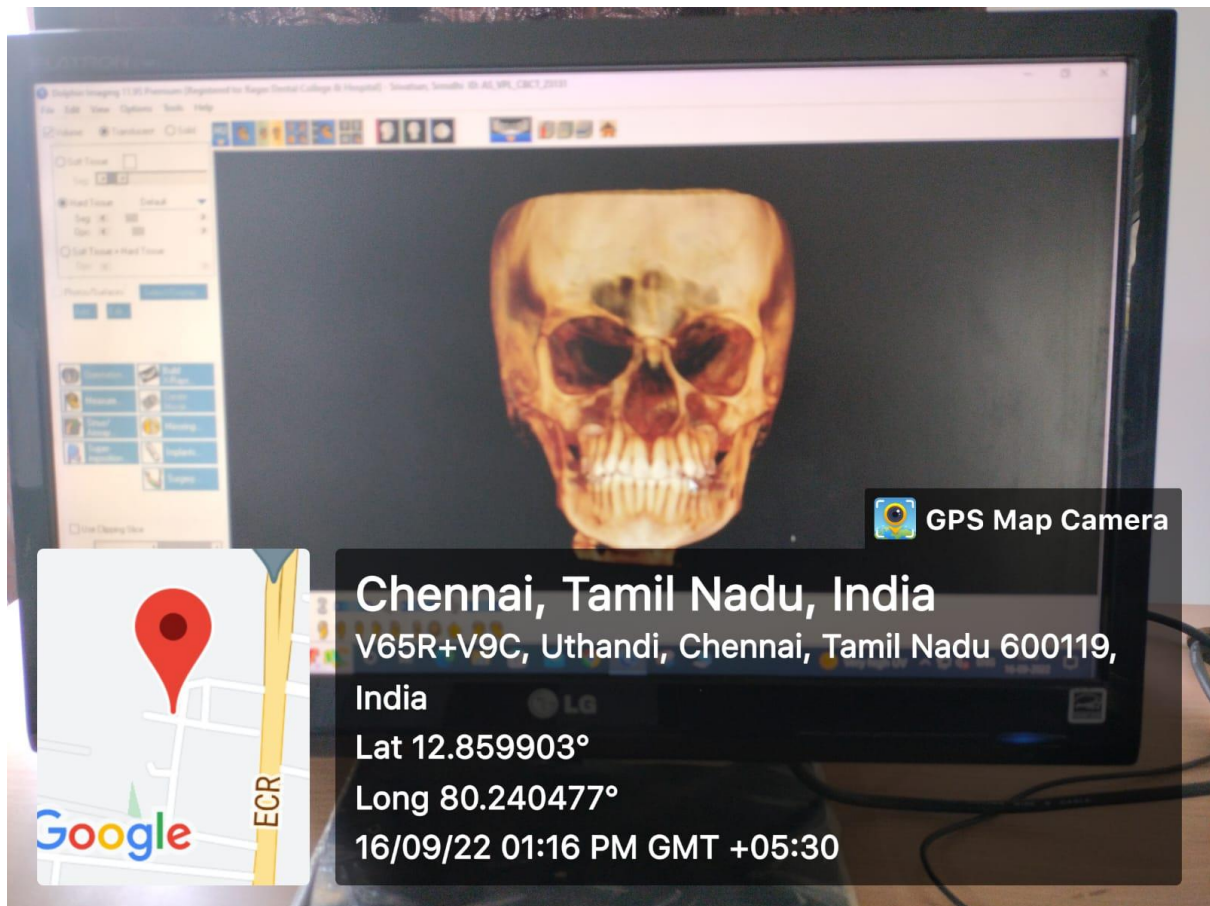



RAGAS DENTAL COLLEGE & HOSPITAL

(Unit of Ragas Educational Society)

Recognized by the Dental Council of India, New Delhi
Affiliated to The Tamilnadu Dr. M.G.R. Medical University, Chennai

2/102, East Coast Road, Uthandi, Chennai - 600 119. INDIA.

Tele : (044) 24530002, 24530003 - 06. Principal (Dir) 24530001

E-mail : principal@rdc.ac.in, web : www.rdc.ac.in

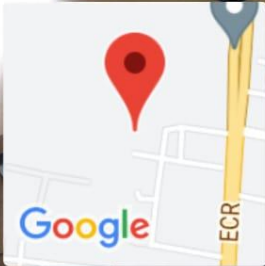
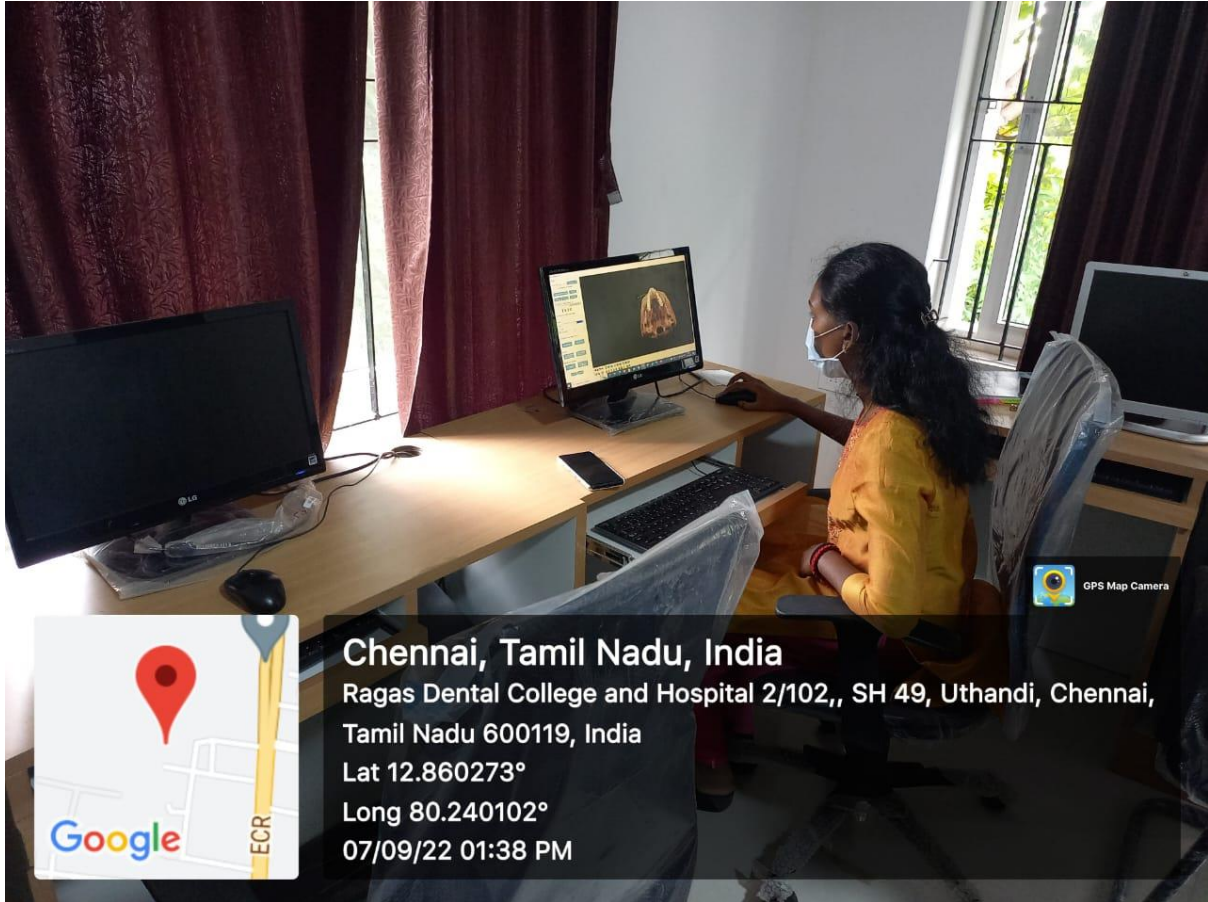

Chennai, Tamil Nadu, India

Ragas Dental College and Hospital 2/102,, SH 49, Uthandi, Chennai,
Tamil Nadu 600119, India

Lat 12.860273°

Long 80.240102°

07/09/22 01:38 PM



RAGAS DENTAL COLLEGE & HOSPITAL

(Unit of Ragas Educational Society)
Recognized by the Dental Council of India, New Delhi
Affiliated to The Tamilnadu Dr. M.G.R. Medical University, Chennai
2/102, East Coast Road, Uthandi, Chennai - 600 119. INDIA.
Tele : (044) 24530002, 24530003 - 06. Principal (Dir) 24530001
E-mail : principal@rdc.ac.in, web : www.rdc.ac.in

MIMICS SOFTWARE



Fwd: Your Materialise Software Pa...



Dear Sir, Madam,

Thank you for your Key file request. Attached you will find the Key file to activate your Materialise software. Store the Key file locally on your computer and browse for this Key file from the registration window of your software, then you can start enjoying the power of Mimics.

Password: 9D0BE8670BF52F0B0D249767BAXC

This password is valid for:

Materialise Software: **Mimics 12.1**

Your System ID: **AB150C33B3XC**

This password will be valid until **Thursday, September 22, 2022**

We are convinced that Mimics will prove to be an essential tool for the optimal completion of your projects. Please don't hesitate to contact [your local Materialise office or representative](#) if you have any questions. We'll be glad to be of assistance.

Best regards,

The Mimics team



RAGAS DENTAL COLLEGE & HOSPITAL

(Unit of Ragas Educational Society)
Recognized by the Dental Council of India, New Delhi
Affiliated to The Tamilnadu Dr. M.G.R. Medical University, Chennai
2/102, East Coast Road, Uthandi, Chennai - 600 119. INDIA.
Tele : (044) 24530002, 24530003 - 06. Principal (Dir) 24530001
E-mail : principal@rdc.ac.in, web : www.rdc.ac.in

ENDODONTIC MICROSCOPE

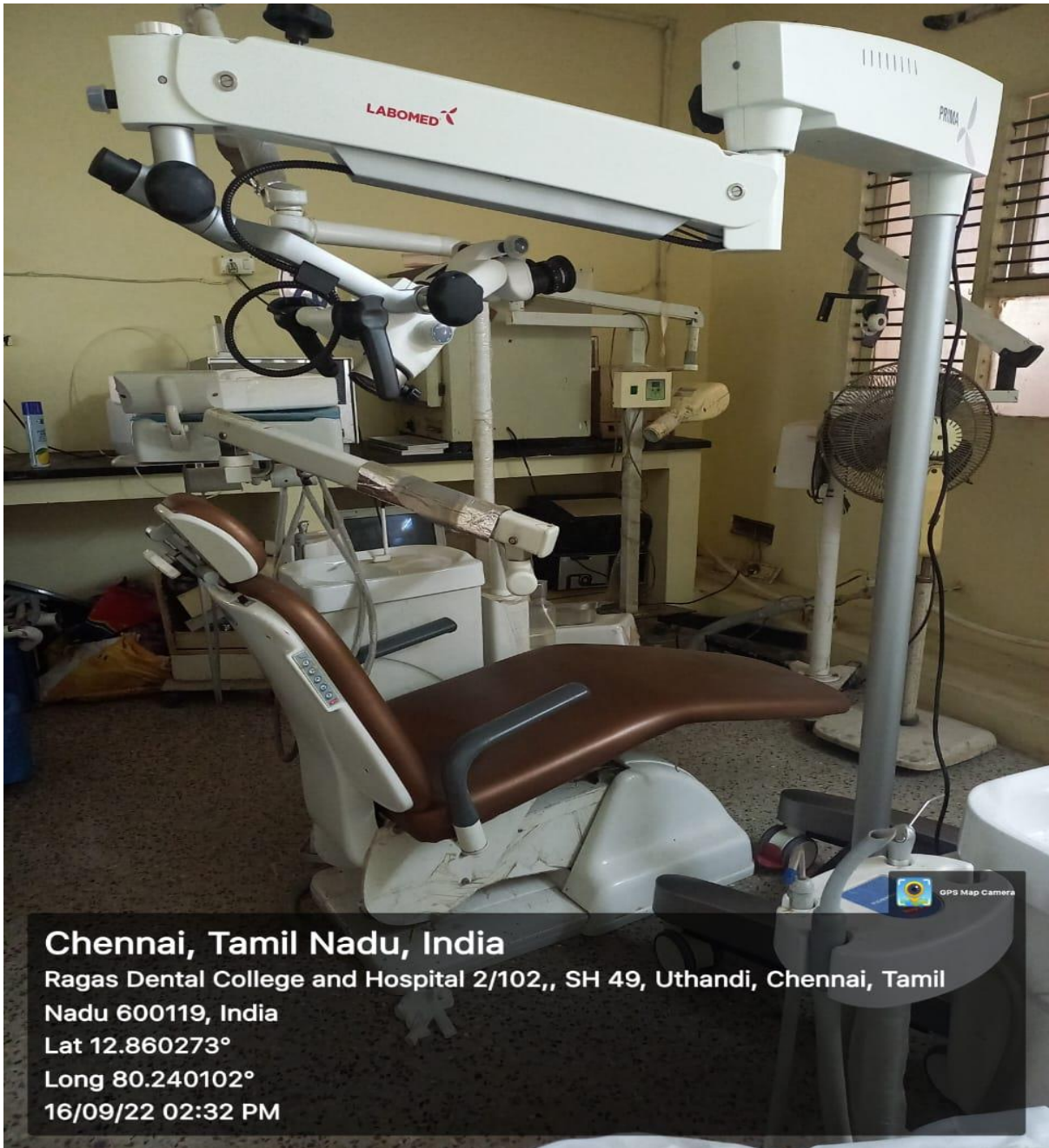

Chennai, Tamil Nadu, India

Ragas Dental College and Hospital 2/102,, SH 49, Uthandi, Chennai, Tamil Nadu 600119, India

Lat 12.860273°

Long 80.240102°

16/09/22 02:32 PM



RAGAS DENTAL COLLEGE & HOSPITAL

(Unit of Ragas Educational Society)
Recognized by the Dental Council of India, New Delhi
Affiliated to The Tamilnadu Dr. M.G.R. Medical University, Chennai
2/102, East Coast Road, Uthandi, Chennai - 600 119. INDIA.
Tele : (044) 24530002, 24530003 - 06. Principal (Dir) 24530001
E-mail : principal@rdc.ac.in, web : www.rdc.ac.in

DENTAL LASER UNIT

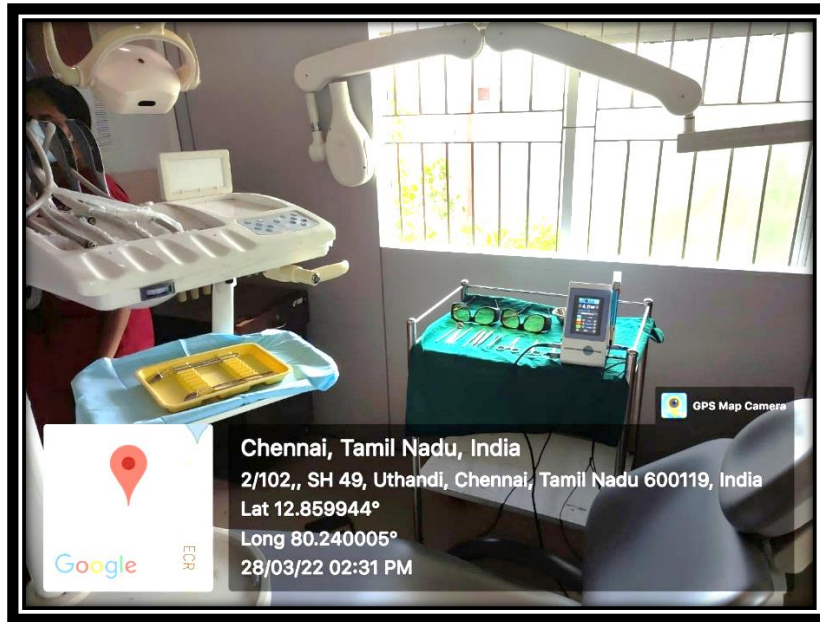

MICROSCOPES AND IHC SET UP





RAGAS DENTAL COLLEGE & HOSPITAL

(Unit of Ragas Educational Society)
Recognized by the Dental Council of India, New Delhi
Affiliated to The Tamilnadu Dr. M.G.R. Medical University, Chennai
2/102, East Coast Road, Uthandi, Chennai - 600 119. INDIA.
Tele : (044) 24530002, 24530003 - 06. Principal (Dir) 24530001
E-mail : principal@rdc.ac.in, web : www.rdc.ac.in

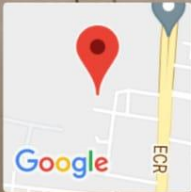

Chennai, Tamil Nadu, India

Ragas Dental College and Hospital, 2/102,, SH 49, Uthandi, Chennai, Tamil Nadu 600119, India

Lat 12.860225°

Long 80.240177°

12/04/22 12:33 PM



RAGAS DENTAL COLLEGE & HOSPITAL

(Unit of Ragas Educational Society)

Recognized by the Dental Council of India, New Delhi
Affiliated to The Tamilnadu Dr. M.G.R. Medical University, Chennai

2/102, East Coast Road, Uthandi, Chennai - 600 119. INDIA.

Tele : (044) 24530002, 24530003 - 06. Principal (Dir) 24530001

E-mail : principal@rdc.ac.in, web : www.rdc.ac.in

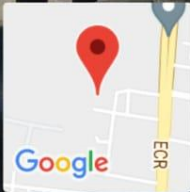
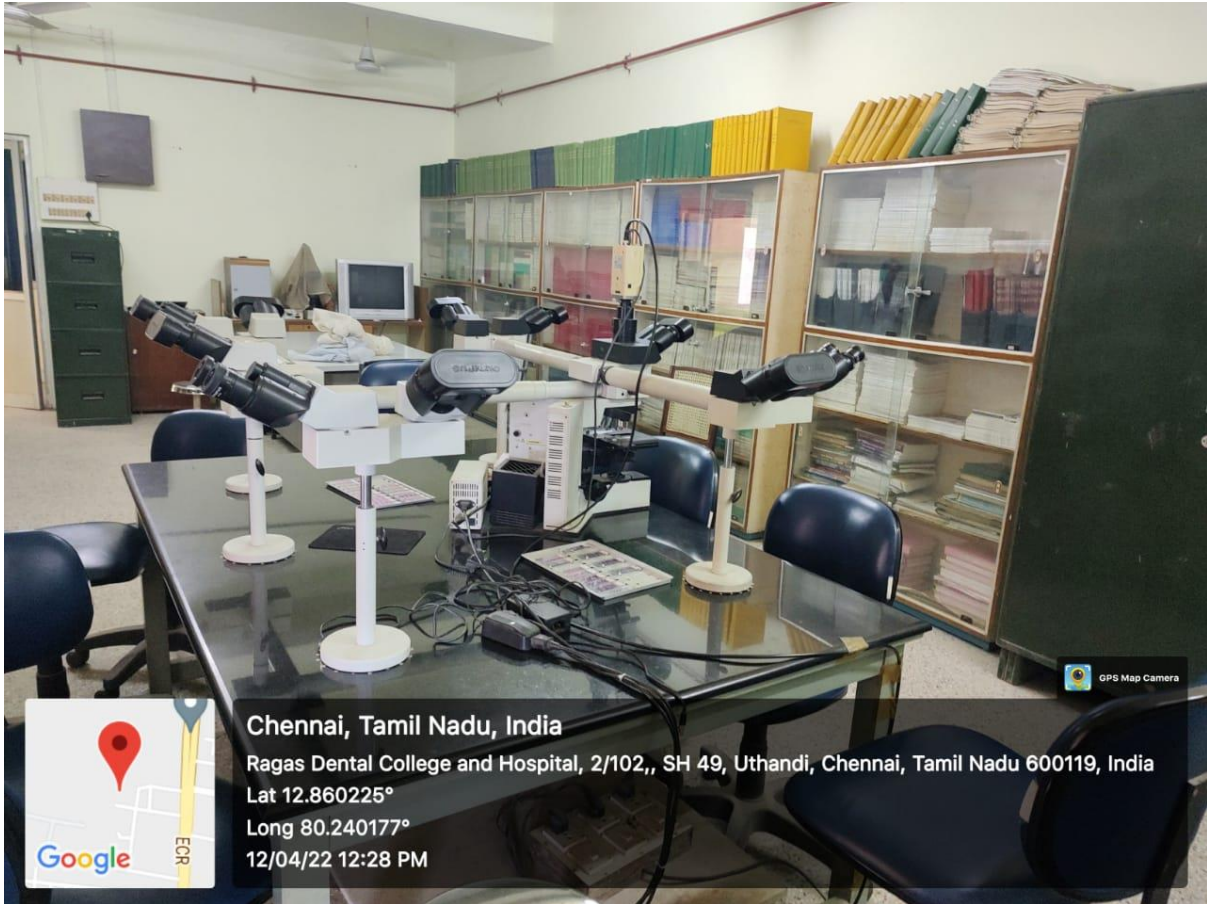

Chennai, Tamil Nadu, India

Ragas Dental College and Hospital, 2/102,, SH 49, Uthandi, Chennai, Tamil Nadu 600119, India

Lat 12.860225°

Long 80.240177°

12/04/22 12:28 PM

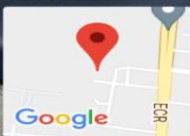
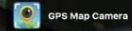

Chennai, Tamil Nadu, India

Ragas Dental College and Hospital, 2/102,, SH 49, Uthandi, Chennai, Tamil Nadu 600119, India

Lat 12.860225°

Long 80.240177°

12/04/22 12:28 PM





RAGAS DENTAL COLLEGE & HOSPITAL

(Unit of Ragas Educational Society)
Recognized by the Dental Council of India, New Delhi
Affiliated to The Tamilnadu Dr. M.G.R. Medical University, Chennai
2/102, East Coast Road, Uthandi, Chennai - 600 119. INDIA.
Tele : (044) 24530002, 24530003 - 06. Principal (Dir) 24530001
E-mail : principal@rdc.ac.in, web : www.rdc.ac.in

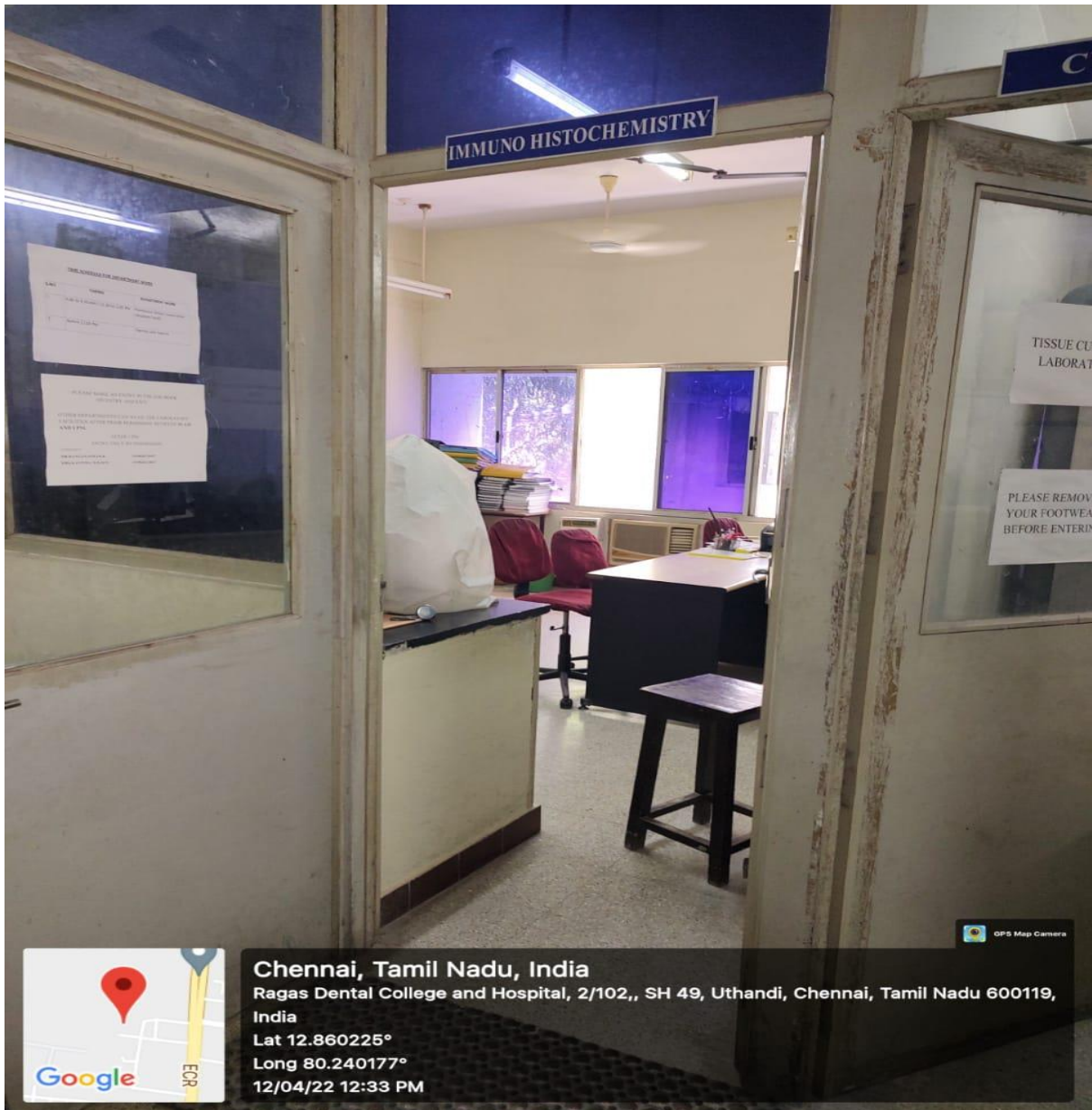

PRINCIPAL
RAGAS DENTAL COLLEGE AND HOSPITAL
UTHANDI, CHENNAI-600 119.